

RYOBI

Aquila *Aquila Z* PLUMA

Baitcasting Reel RIGHT Handle & LEFT Handle

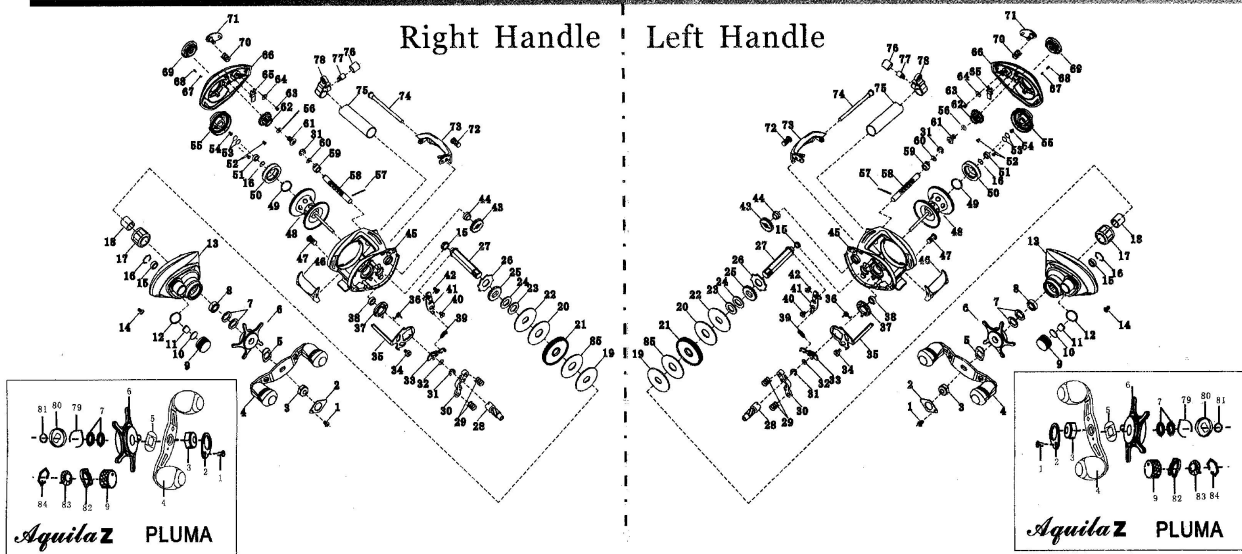

NO.	PART NAME	NO.	PART NAME	NO.	PART NAME
1	Handle Retaining Screw	29	Clutch Spring	57	Carriage Screw Pin
2	Handle Retaining Plate	30	Clutch Bar	58	Carriage Screw
3	Nut	31	Retaining Ring	59	Bushing
4	Handle Assembly(2BB/4BB)	32	Washer	60	Washer
5	Washer	33	Kick Claw	61	Screw
6	Star Handle	34	Clutch Cam Screw	62	Adjusting Gear
7	Drag Spring Washer	35	Clutch Cam Plate	63	Screw
8	Ball Bearing (1BB)	36	Dead Point Spring	64	Washer
9	Cast Control Knob	37	Clutch Cam	65	Lock Plate
10	Rubber	38	Ball Bearing(1BB)	66	Left Cover
11	Brake Piece	39	Kick Claw Spring	67	Click Spring
12	O Ring	40	Screw	68	Click Pin
13	Right Side Plate	41	Stopper	69	Brake Adjustment Knob
14	Screw	42	Screw	70	Spring
15	Ball Bearing (2BB)	43	Carriage Screw Gear	71	Left Cover Push Button
16	Stopper Ring	44	Carriage Screw Bushing	72	Screw
17	One Way Clutch	45	Frame	73	Front Cover
18	One Way Clutch Collar	46	Clutch Lever	74	Connecting Screw
19	Drag Washer	47	Screw	75	Stabilizer Bar
20	Drag Washer	48	Spool Assembly(1BB)	76	Pawl Cap
21	Main Gear	49	Stopper Spring	77	Return Pawl
22	Drag Washer	50	Magnet Holder	78	Holder Assembly
23	Drag Washer	51	Ball Bearing (1BB)	79	Click Spring
24	Washer	52	Screw	80	Click Holder
25	Connect Gear	53	Washer	81	Bushing
26	Ratchet	54	Screw	82	Click
27	Ratchet Gear Shaft	55	Spool Cover Assembly	83	Click Plate
28	Pinion Gear	56	Washer	84	Stopper Ring
				85	Drag Washer

Specifications

NAME	Model	Weight(g)	Gear Ratio	Bearings	Line Capacity mm/m
<i>Aquila</i>	RH & LH	215	6.3:1	8Ball 1Roller	0.235-200 0.285-130
<i>Aquila Z</i>	RH & LH	195	6.3:1	8Ball 1Roller	0.235-200 0.285-130
PLUMA	RH & LH	165	7.1:1	10Ball 1 Roller	0.235-200 0.285-130